

CABINET

DOCUMENTS FOR THE MEMBERS ROOM

Tuesday, 13th November, 2012
at 5.00 pm

MEMBERS ROOM DOCUMENTS ATTACHED TO THE
LISTED REPORTS

Contacts

Cabinet Administrator

Judy Cordell

Tel: 023 8083 2766

Email: judy.cordell@southampton.gov.uk

MEMBERS ROOM DOCUMENTS

10 CIVIL SERVICE SPORTS GROUND - APPROVAL TO SPEND

- Drawings 1-1.6

Monday, 5 November 2012

HEAD OF LEGAL , HR AND DEMOCRATIC SERVICES

Agenda Item 10

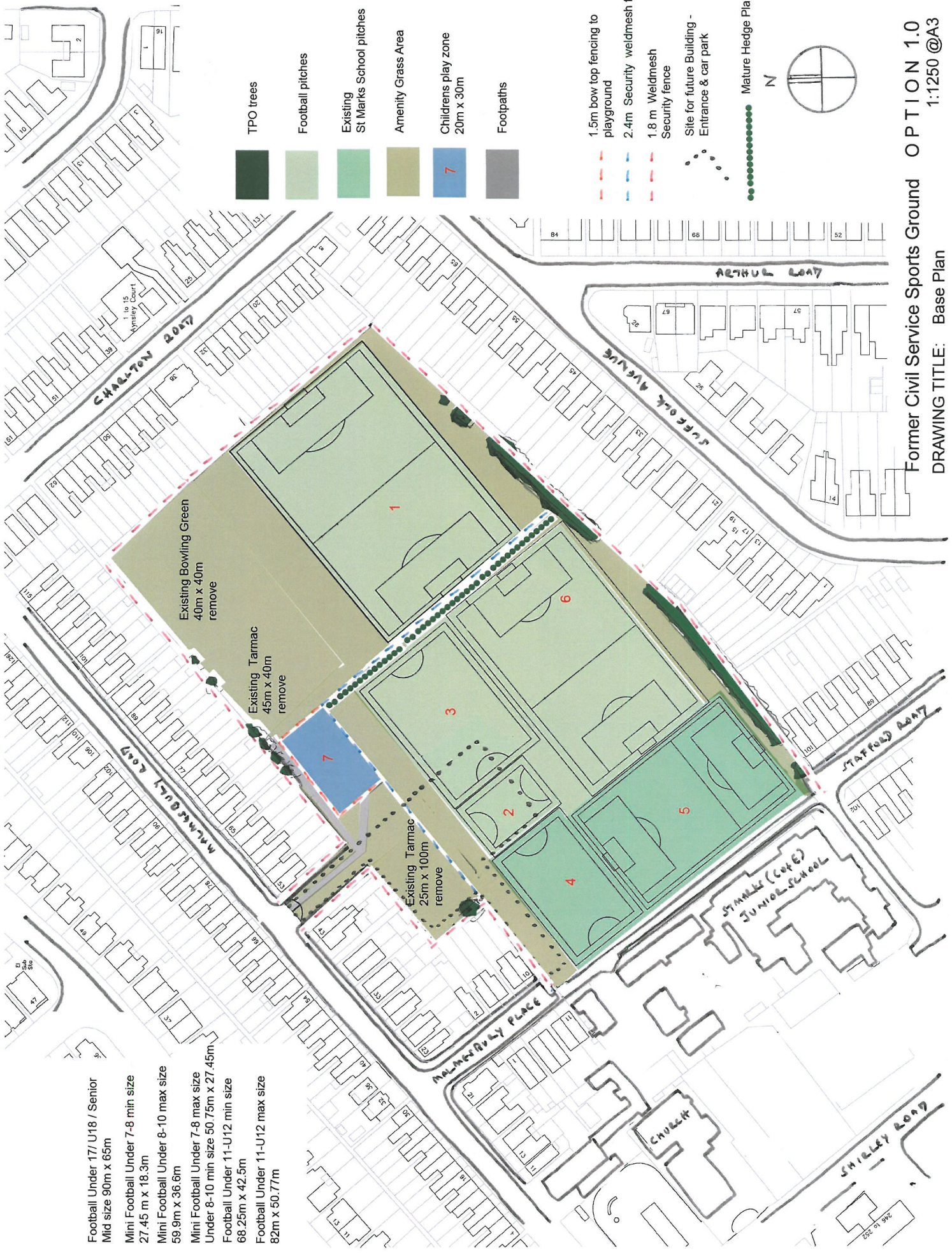

- TPO trees
- Football pitches
- Existing St Marks School pitches
- Amenity Grass Area
- Childrens play zone 20m x 30m
- Footpaths

- 1.5m bow top fencing to playground
- 2.4m Security weldmesh fence
- 1.8 m Weldmesh Security fence
- Site for future Building - Entrance & car park
- Mature Hedge Planting

- 1 Football Under 17/ U18 / Senior Mid size 90m x 65m
- 2 Mini Football Under 7-8 min size 27.45 m x 18.3m
- 3 Mini Football Under 8-10 max size 59.9m x 36.6m
- 4 Mini Football Under 7-8 max size Under 8-10 min size 50.75m x 27.45m
- 5 Football Under 11-U12 min size 68.25m x 42.5m
- 6 Football Under 11-U12 max size 82m x 50.77m

Former Civil Service Sports Ground **OPTION 1.0**
 DRAWING TITLE: Base Plan
 1:1250 @A3

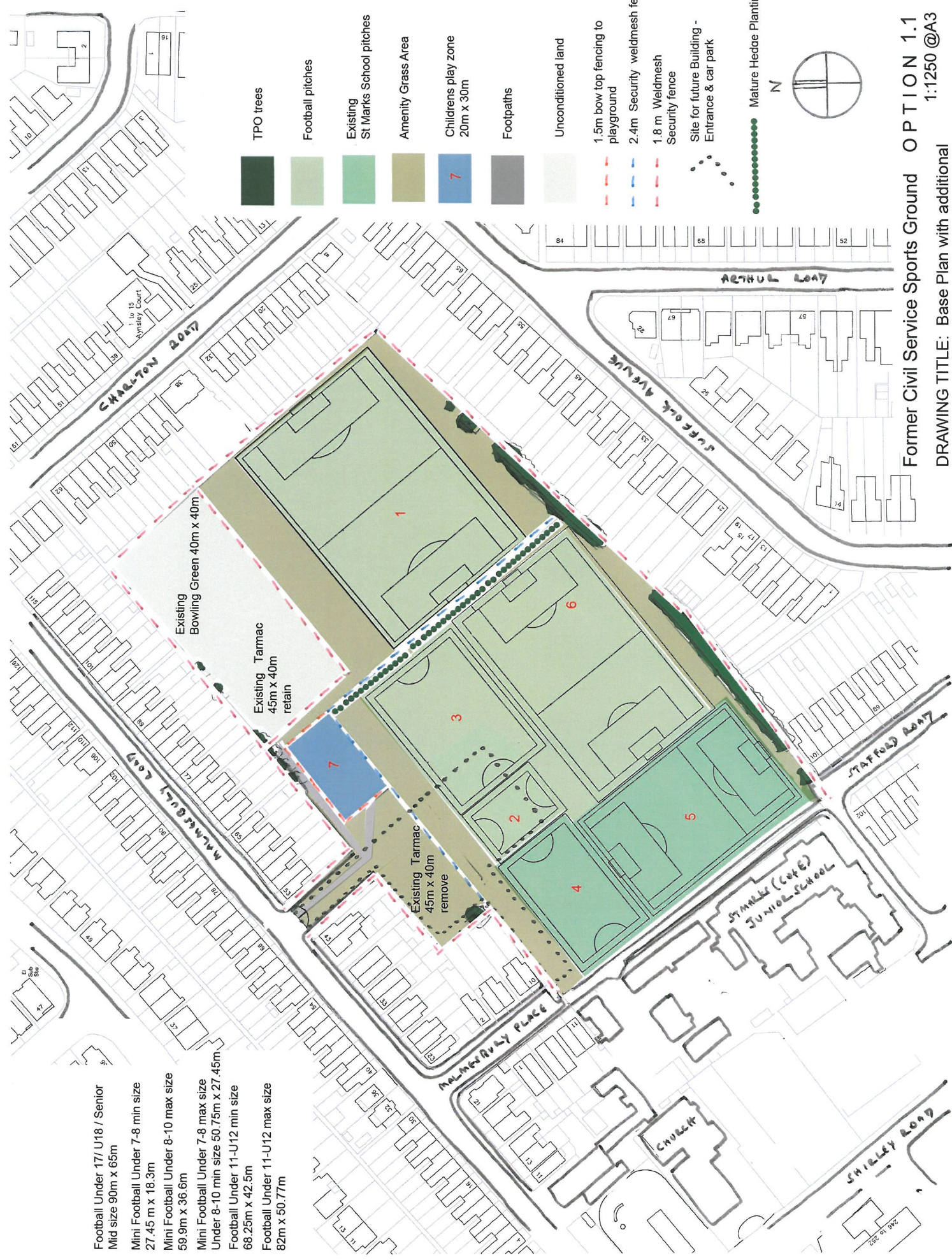

- 1 Football Under 17/ U18 / Senior
Mid size 90m x 65m
- 2 Mini Football Under 7-8 min size
27.45 m x 18.3m
- 3 Mini Football Under 8-10 max size
59.9m x 36.6m
- 4 Mini Football Under 7-8 max size
Under 8-10 min size 50.75m x 27.45m
- 5 Football Under 11-U12 min size
68.25m x 42.5m
- 6 Football Under 11-U12 max size
82m x 50.77m

- TPO trees
- Football pitches
- Existing St Marks School pitches
- Amenity Grass Area
- Childrens play zone 20m x 30m
- Footpaths
- Unconditioned land
- 1.5m bow top fencing to playground
- 2.4m Security weldmesh fence
- 1.8 m Weldmesh Security fence
- Site for future Building - Entrance & car park
- Mature Hedde Planting

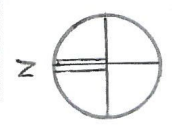

Former Civil Service Sports Ground **OPTION 1.1**
 1:1250 @A3
 DRAWING TITLE: Base Plan with additional
 fence to existing tarmac / bowling area

- 1 New Conditioned Amenity Grass
- 2 Mini Football Under 7-8 min size 27.45 m x 18.3m
- 3 Mini Football Under 8-10 max size 59.9m x 36.6m
- 4 Mini Football Under 7-8 max size Under 8-10 min size 50.75m x 27.45m
- 5 Football Under 11-U12 min size 68.25m x 42.5m
- 6 Football Under 11-U12 max size 82m x 50.77m



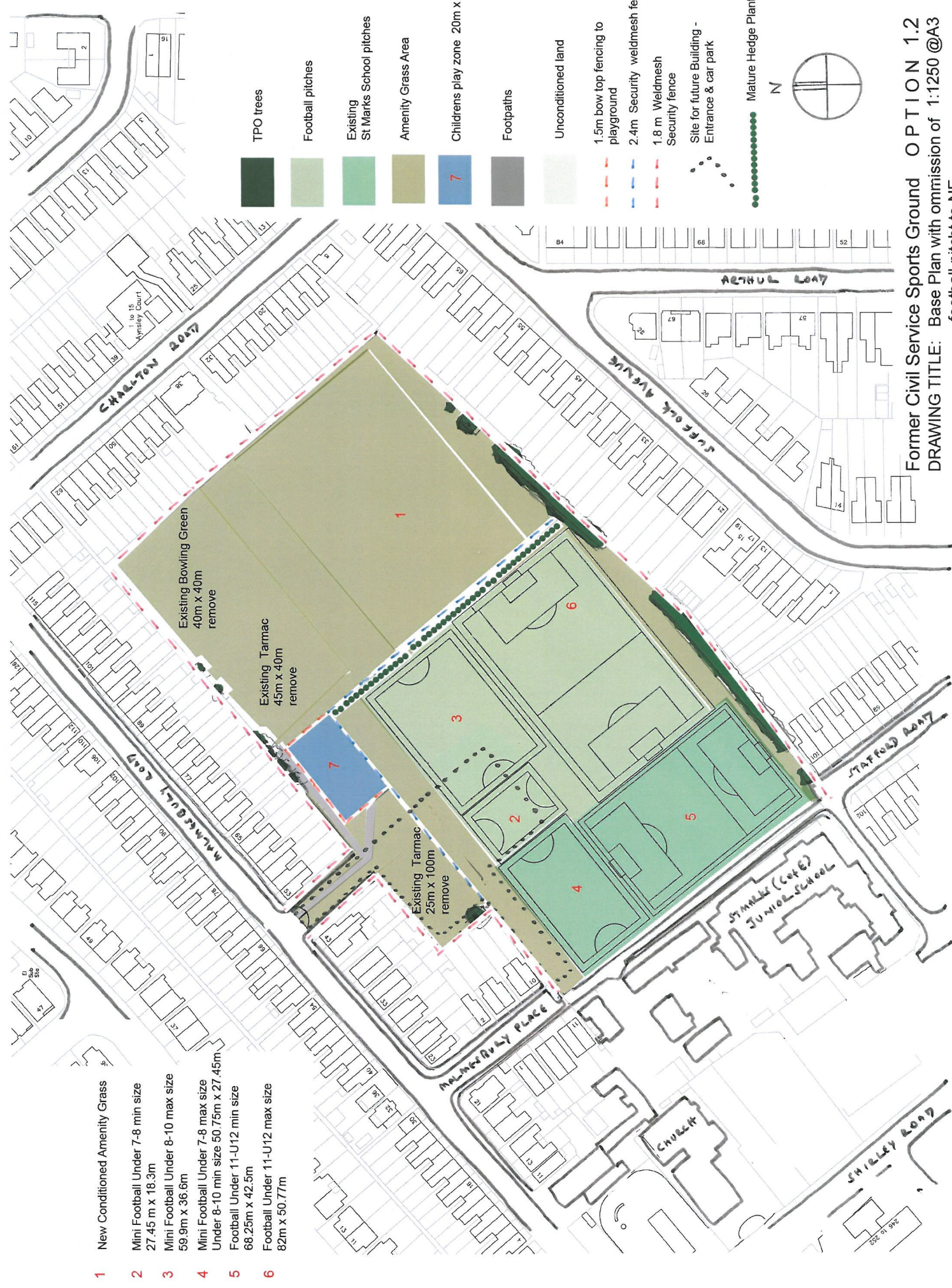
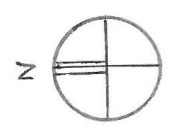

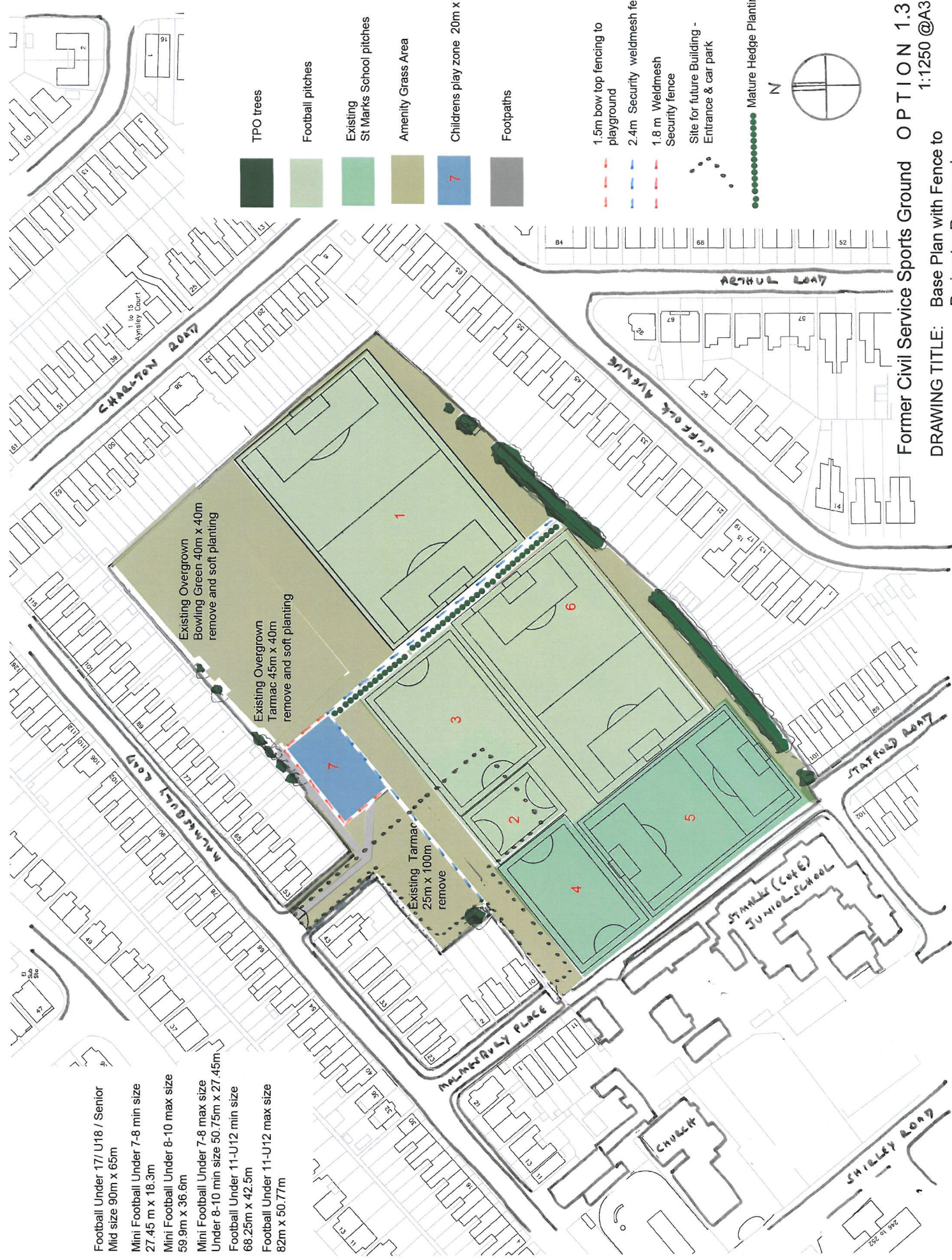

- TPO trees
- Football pitches
- Existing St Marks School pitches
- Amenity Grass Area
- Childrens play zone 20m x 30m
- Footpaths
- Unconditioned land
- 1.5m bow top fencing to playground
- 2.4m Security weldmesh fence
- 1.8 m Weldmesh Security fence
- Site for future Building - Entrance & car park
- Mature Hedge Planting







Former Civil Service Sports Ground OPTION 1.2
 DRAWING TITLE: Base Plan with omission of 1:1250 @A3
 football pitch to NE



- 1** Football Under 17/ U18 / Senior
Mid size 90m x 65m
- 2** Mini Football Under 7-8 min size
27.45 m x 18.3m
- 3** Mini Football Under 8-10 max size
59.9m x 36.6m
- 4** Mini Football Under 7-8 max size
Under 8-10 min size 50.75m x 27.45m
- 5** Football Under 11-U12 min size
68.25m x 42.5m
- 6** Football Under 11-U12 max size
82m x 50.77m

	TPO trees
	Football pitches
	Existing St Marks School pitches
	Amenity Grass Area
	Childrens play zone 20m x 30m
	Footpaths

	1.5m bow top fencing to playground
	2.4m Security weldmesh fence
	1.8 m Weldmesh Security fence
	Site for future Building - Entrance & car park
	Mature Hedge Planting

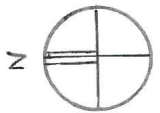

Former Civil Service Sports Ground **OPTION 1.3**
 DRAWING TITLE: Base Plan with Fence to Perimeter Removed
 1:1250 @A3

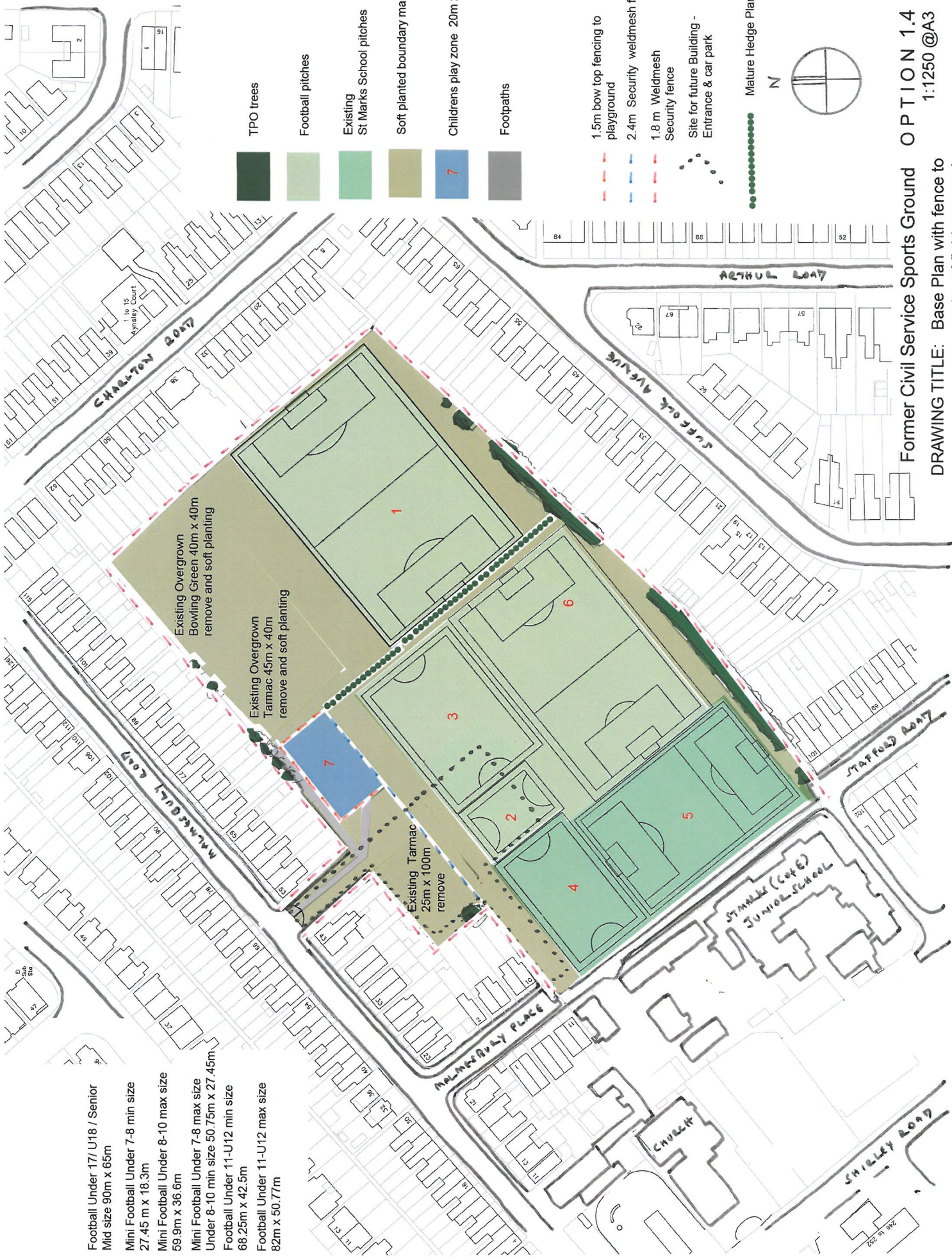

- 1 Football Under 17/ U18 / Senior
Mid size 90m x 65m
- 2 Mini Football Under 7-8 min size
27.45 m x 18.3m
- 3 Mini Football Under 8-10 max size
59.9m x 36.6m
- 4 Mini Football Under 7-8 max size
Under 8-10 min size 50.75m x 27.45m
Football Under 11-U12 min size
68.25m x 42.5m
- 5 Football Under 11-U12 max size
82m x 50.77m

- TPO trees
- Football pitches
- Existing St Marks School pitches
- Soft planted boundary margin
- Childrens play zone 20m x 30m
- Footpaths
- 1.5m bow top fencing to playground
- 2.4m Security weldmesh fence
- 1.8 m Weldmesh Security fence
- Site for future Building - Entrance & car park
- Mature Hedge Planting

Former Civil Service Sports Ground **OPTION 1.4**
 1:1250 @A3

DRAWING TITLE: Base Plan with fence to
 centre of field removed

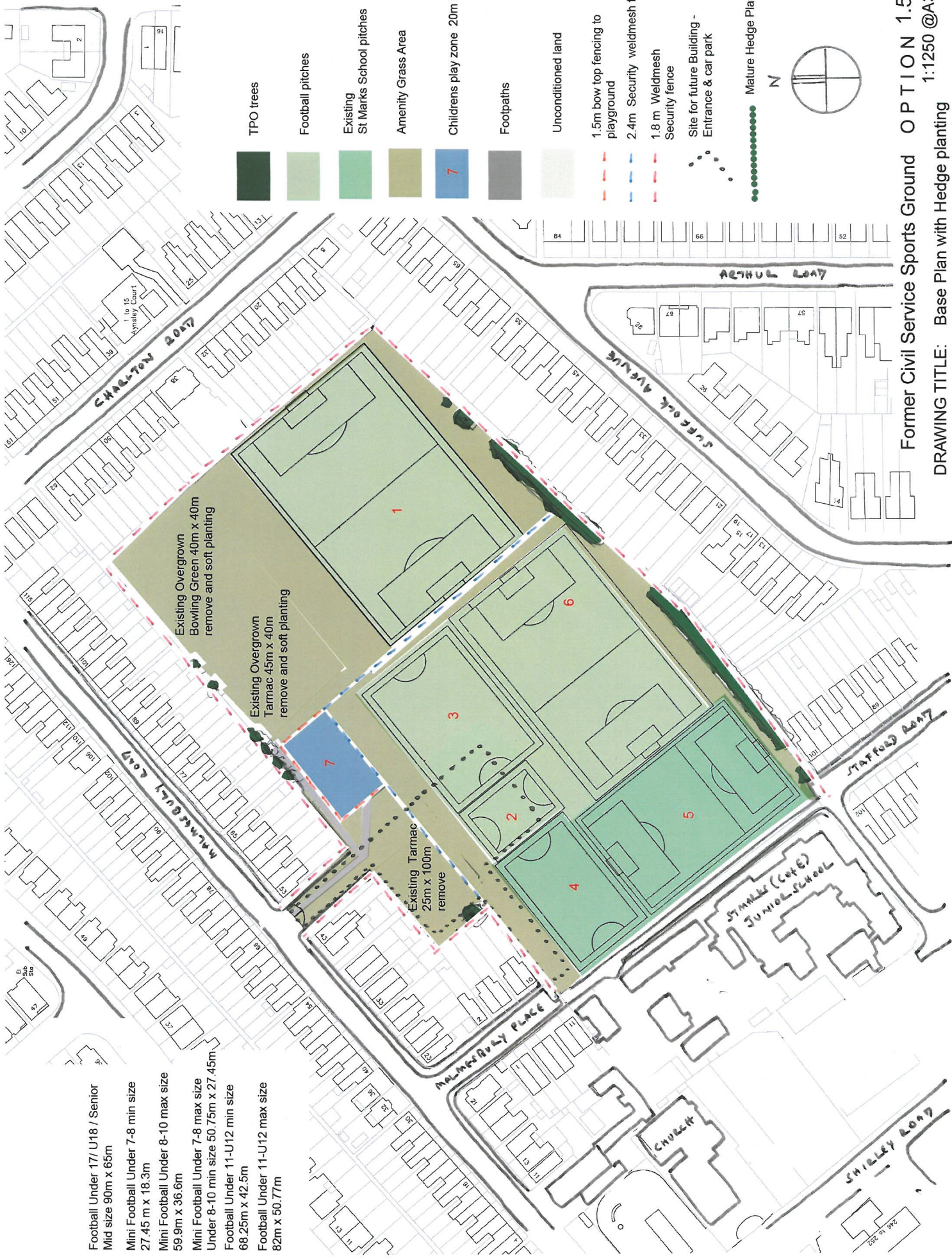

- 1 Football Under 17/ U18 / Senior
Mid size 90m x 65m
- 2 Mini Football Under 7-8 min size
27.45 m x 18.3m
- 3 Mini Football Under 8-10 max size
59.9m x 36.6m
- 4 Mini Football Under 7-8 max size
Under 8-10 min size 50.75m x 27.45m
- 5 Football Under 11-U12 min size
68.25m x 42.5m
- 6 Football Under 11-U12 max size
82m x 50.77m

- TPO trees
- Football pitches
- Existing St Marks School pitches
- Amenity Grass Area
- Childrens play zone 20m x 30m
- Footpaths
- Unconditioned land
- 1.5m bow top fencing to playground
- 2.4m Security weldmesh fence
- 1.8 m Weldmesh Security fence
- Site for future Building - Entrance & car park
- Mature Hedge Planting

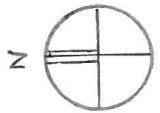

Former Civil Service Sports Ground **OPTION 1.5**
 1:1250 @A3
 DRAWING TITLE: Base Plan with Hedge planting
 to centre of field removed

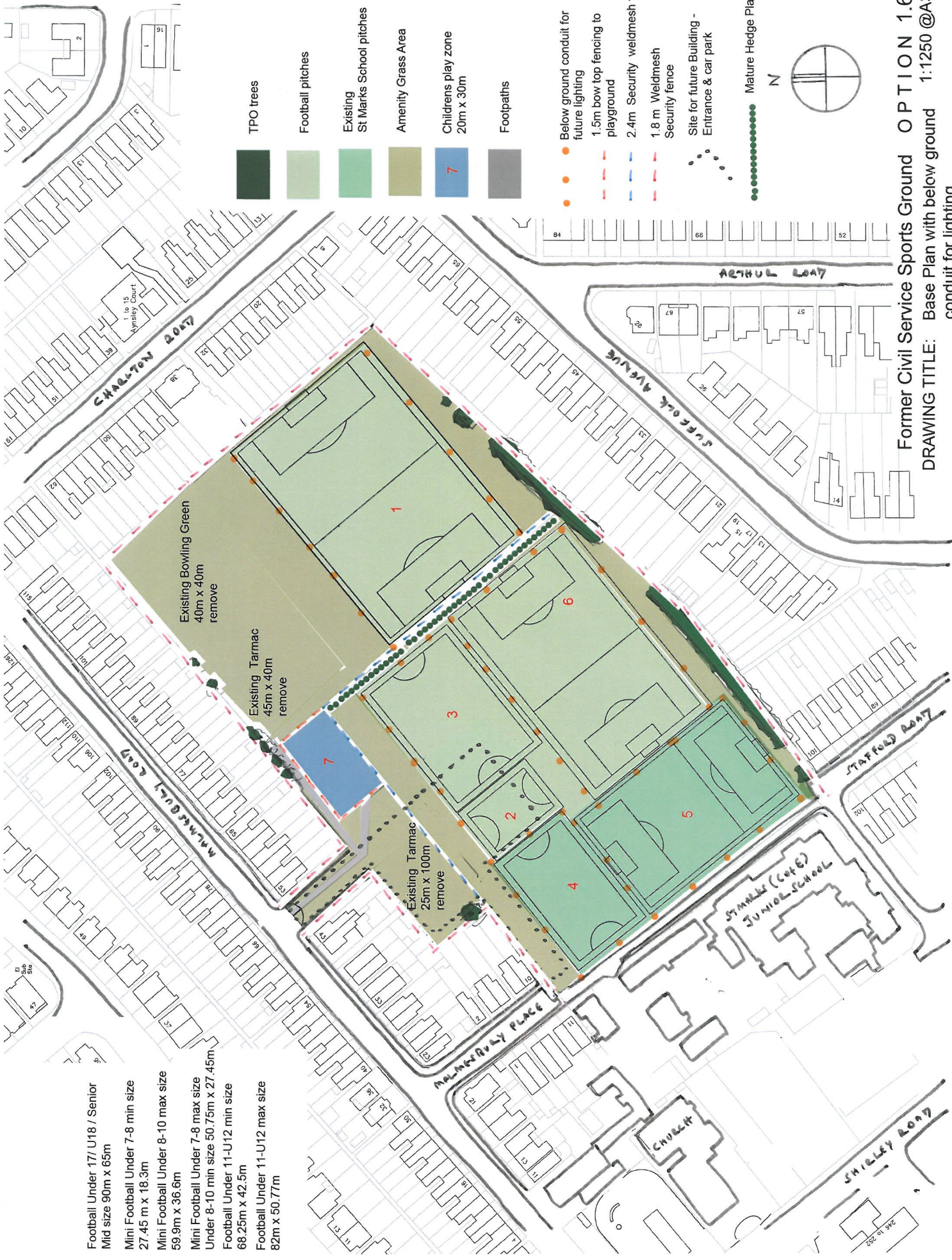

- TPO trees
- Football pitches
- Existing St Marks School pitches
- Amenity Grass Area
- Childrens play zone 20m x 30m
- Footpaths

- Below ground conduit for future lighting
- 1.5m bow top fencing to playground
- 2.4m Security weldmesh fence
- 1.8 m Weldmesh Security fence
- Site for future Building - Entrance & car park
- Mature Hedge Planting

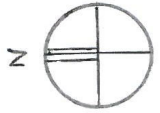

- 1 Football Under 17/ U18 / Senior Mid size 90m x 65m
- 2 Mini Football Under 7-8 min size 27.45 m x 18.3m
- 3 Mini Football Under 8-10 max size 59.9m x 36.6m
- 4 Mini Football Under 7-8 max size Under 8-10 min size 50.75m x 27.45m
- 5 Football Under 11-U12 min size 68.25m x 42.5m
- 6 Football Under 11-U12 max size 82m x 50.77m

Former Civil Service Sports Ground OPTION 1.6
 DRAWING TITLE: Base Plan with below ground conduit for lighting

Scale: 1:1250 @A3

This page is intentionally left blank